



BRUMBERG

ON LIGHT

QUBIC 4" LED SURFACE MOUNT

BUILD YOUR CODE

PRODUCT	LUMENS	LED COLOR	CRI	BEAM SPREAD	VOLTAGE	HOUSING COLOR	DIMMING OPTION
QUBIC	12 1200 LM (9W) 18 1800 LM (15W) *custom lumen output available on request	27 2700 K 30 3000 K 35 3500 K 40 4000 K	80 80 CRI 90 90 CRI	SP 15° NFL 25° FL 38° WFL 60° *93% efficacy	1 120V	WH RAL 9016 white BK RAL 9005 black + Custom finish	ADIM 0-10V 5%* TRIAC Triac dim. Line voltage dim. DALI DALI* — None *for 0-10V or DALI, dimming driver must be remote. **standard option



MADE IN

MOUNTING OPTION <i>Order as separately</i>	
CJM	Surface mount on octagonal junction box with adapter plate*
SMD	Surface mount with adapter plate - mud in dry wall ceiling*
ACM10	10ft aircraft cable mount
S10	10ft suspension set**
*when driver is remote adapter plate is not needed **Aircraft cable is combined inside power cord, designed for sleek and simple installation.	

DIMENSIONS

*dimension are in mm

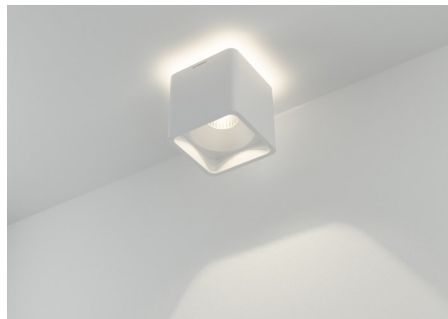
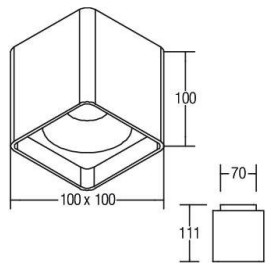

ON LIGHT CHEAT SHEET :

- Nominal Efficacy : up to 90 LM/W.
- Dry & Damp location Ingress protection IP20. Applications in wet locations will void warranty.
- Lumen maintenance L80/B10 : 50 000h at 25°C.
- Lumen maintenance for LED's tested by LED chip manufacturer in accordance with IESNA LM80-08.
- 5-year warranty on LED light engine, driver and all lighting fixture components.
- Input class 2: 15W / 120V.
- Die-cast aluminum housing construction.
- Certified to US and Canadian safety standards.
- Installation for Damp & dry location only : IP54
- Roughed textured powder-coated paint finish.
- On Octagonal junction box installation
- Luminaires are assembled in Beloeil, Canada.

Height : 4-3/8" (111mm)

Long x Long : 3-15/16" (100x100mm)

DELIVERED LUMEN <i>Nominal value at 3500K & 84 CRI</i>															
CCT OPTION	2700K	2700K	2700K	3000K	3000K	3000K	3500K	3500K	3500K	4000K	4000K	4000K	Bread	Meat	Fish
CRI OPTION	80	90	97	80/A	90	97	84	90	A/80	84	90	A/80	80	80	80
MULTIPLIER	.93	.77	.67	.96	.80	.71	1	.83	.78	1.0	0.86	.83	.86	.53	1

Last update 1/13/2024

Due to continuous improvements, the information herein may be changed without notice