



BRUMBERG

ON LIGHT

QUBIC 4" LED SURFACE MOUNT

BUILD YOUR CODE



PRODUCT	LUMENS	LED COLOR	CRI	BEAM SPREAD	VOLTAGE	HOUSING COLOR	DIMMING OPTION	MOUNTING
QUBIC	12 1200 LM (15W) 18 1800 LM (19W)	27 2700 K 30 3000 K 35 3500 K 40 4000 K	80 80 CRI	WFL 60°	1 120V 2 277V	WH RAL 9016 white BK RAL 9005 black + Custom color	ADIM 0-10V 5% TRIAC Triac dim. Line voltage dim. None *Bluetooth control via Casambi app	SM Surface mount on octagonal junction box

DIMENSIONS

*dimension are in mm

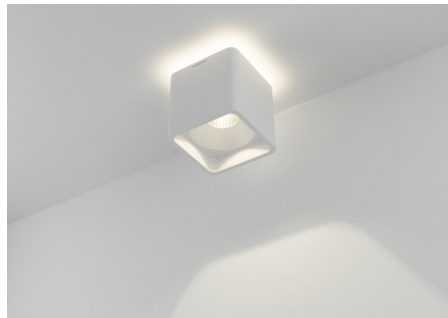
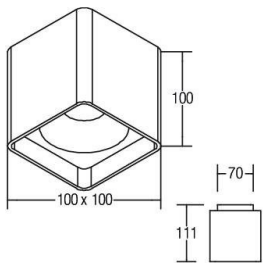

ON LIGHT CHEAT SHEET :

- Nominal Efficacy : up to 90 LM/W.
- Dry & Damp location Ingress protection IP20. Applications in wet locations will void warranty.
- Lumen maintenance L80/B10 : 50 000h at 25°C.
- Lumen maintenance for LED's tested by LED chip manufacturer in accordance with IESNA LM80-08.
- 5-year warranty on LED light engine, driver and all lighting fixture components.
- Input class 2: 25W / 120V.
- Die-cast aluminum housing construction.
- Certified to US and Canadian safety standards.
- Roughed textured powder-coated paint finish.
- On Octagonal junction box installation
- Luminaires are assembled in Beloeil, Canada.

Weight trim: 4-3/8" (111mm)

Height: 3-15/16" (100x100mm)

DELIVERED LUMEN <i>Nominal value at 3500K & 84 CRI</i>															
CCT OPTION	2700K	2700K	2700K	3000K	3000K	3000K	3500K	3500K	3500K	4000K	4000K	4000K	Bread	Meat	Fish
CRI OPTION	80	90	97	80/A	90	97	84	90	A/80	84	90	A/80	80	80	80
MULTIPLIER	.93	.77	.67	.96	.80	.71	1	.83	.78	1.0	0.86	.83	.86	.53	1

Last update 11/15/2022

Due to continuous improvements, the information herein may be changed without notice