



**SWAP** Tool-less interchangeable reflector assembly system  
**SHIP2FAST** Fast delivery program

**ansorg**

ON LIGHT

**Iqona ILT**

4-1/2" LED TRACK LIGHT



MADE IN

PRODUCT	DELIVERED LUMENS	LED COLOR	CRI	BEAM SPREAD	DIMMING	HOUSING COLOR	MOUNTING
<b>Iqona ILT</b>	<b>20</b> 2000 LM (14W)	<b>27</b> 2700 K	<b>80</b> 80 CRI min. value	<b>SP</b> 17° (reflector)	<b>ADIM</b> 0-10V dim.	<b>WH</b> RAL 9016 white	<b>3C</b> 3 circuits GLOBAL® or on Stucchi® track system.
	<b>25</b> 2500 LM (17W)	<b>30</b> 3000 K	<b>90</b> 90 CRI min. value	<b>SSP</b> 20° (reflector)		— None dim.	
	<b>30</b> 3000 LM (21W)	<b>35</b> 3500 K	<b>97</b> (2700k 3000K 5600K)	<b>MFL</b> 22° (reflector)		<b>SL</b> RAL 9006 silver	
	<b>35</b> 3500LM (23W)	<b>40</b> 4000 K	<b>A</b> A Class* (3000K, 3500K, 4000K)	<b>FL</b> 37° (reflector)		* Custom color	
	<b>41</b> 4200LM (28W)	<b>50</b> 5000 K		<b>WFL</b> 54° (reflector)			
	<b>51</b> 5200LM (32W)	<b>B</b> Bread color		<b>VWFL</b> 66° (reflector)			
	<b>61</b> 6100LM (35W)	<b>M</b> Meat color					
		<b>F</b> Fish color					

ACCESSORIES : Order as separate part number.	
<b>Stucchi ONE TRACK</b>	4',8',12' 3 circuits track with intergrated DALI/0-10V control Recessed/suface mount/high track , black, grey, white finish + accessories
<b>Global track</b>	4',8',12' 3 circuits track, surface mount only, white & black finish

DELIVERED LUMEN <small>Nominal value at 3500K &amp; 84 CRI</small>															
CCT OPTION	2700K	2700K	2700K	3000K	3000K	3000K	3500K	3500K	3500K	4000K	4000K	4000K	Bread	Meat	Fish
CRI OPTION	84	90	97	80/A	90	97	84	90	A/80	84	90	A/80	80	80	80
MULTIPLIER	.93	.77	.67	.96	.80	.71	1	.83	.78	1.0	0.86	.83	.86	.53	1

**DIMENSIONS**

\*dimensions are in mm

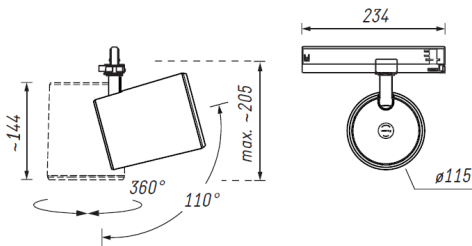

**Weight trim:** 2.0 lb (0.9 kg)

**Diameter:** 4-1/2" (115mm)

**Max height:** 8" (180mm)

Last update 6/17/2022

**ON LIGHT CHEAT SHEET :**

- Nominal Efficacy : up to 141.6 lm/W
- 3-Step MacAdam ellipse color consistency for clean and uniform lighting.
- Lumen maintenance L80/B10 :50 000h ta 25°C
- 5-year warranty on LED light engine, driver and all lighting fixture components.
- Failure rate C0/B10 : 50 000h ta 25°C
- Input class 2: 120V. Max settable intrack driver output :135W / 0.32A
- Light fixture number per circuit breaker 20A : 50
- ETL certified to US and Canadian safety standards.
- Tool-less interchangeable reflector and accessories assembly system.
- Mini. R9 value for 80 CRI CRI is 0. the min. R9 values for 90 LED is 50. the min. R9 value for 97 CRI LED is 93. For Décor series LED, Typical R9 value is 98 to enhance RED's and an R15 value of 97
- Luminaires are assembled in Canada, Beloeil.

Due to continuous improvements, the information herein may be changed without notice



**Z SWAP** Tool-less interchangeable reflector assembly system  
**SHIP2FAST** Fast delivery program

Project:

QUANTITIES:

**ansorg**

ON LIGHT

**Iqona ILT**

4-1/2" LED TRACK LIGHT

